

## Series W-BSCV

### Bronze Swing Check Valve

#### Size: DN15-DN50

The series W-BSCV Swing Check Valve is designed to protect against medium backflow.

#### Features

- Simple structure
- Low head loss
- Long service life

#### Pressure-Temperature

- Nominal Pressure: PN20(300psi)
- Temperature Range: -15°C~120°C

#### Test Pressures

##### Hydraulic

Shell: 30 bar

Seat: 22 bar

#### Material

NO.	Component	Material	Standard
1	Valve Body	Bronze	C87800
2	Valve Disc	Bronze	C87800
3	Valve Bonnet	Bronze	C87800
4	Hinge Pin	Brass	H62
5	Plug	Brass	H62

#### Characteristic Curve

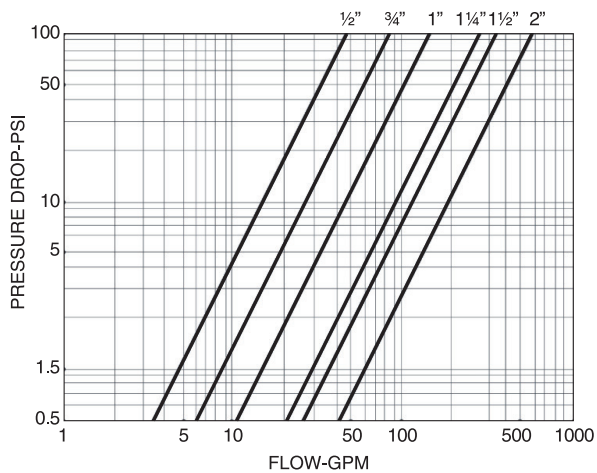

#### Specification

- Connection Standard: NPT to ASME B1.20.1  
BSPT to BS21
- Medium: water, oil, gas

#### Approval

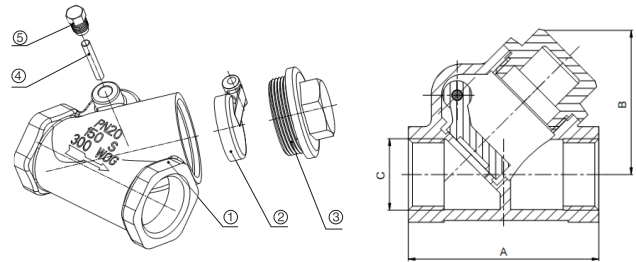

#### Installation Dimensions

Connection Dimensions: ASME B1.20.1

Dimension (mm)	DN(mm)					
	15	20	25	32	40	50
A	56	70.5	80	97	109.5	129
B	42.5	51	58.4	68.7	78.8	95.5
C	1/2"NPT	3/4"NPT	1"NPT	1 1/4"NPT	1 1/2"NPT	2"NPT
Weight(mm)	0.288	0.448	0.619	0.937	1.349	1.93

Connection Dimensions: BS EN 10226 (BS21)

Dimension (mm)	DN(mm)					
	15	20	25	32	40	50
A	56	70.5	80	97	109.5	129
B	42.5	51	58.4	68.7	78.8	95.5
C	1/2"NPT	3/4"NPT	1"NPT	1 1/4"NPT	1 1/2"NPT	2"NPT
Weight(mm)	0.288	0.448	0.619	0.937	1.349	1.93

Watts reserves the right to change or modify product design, construction, specifications, or materials without prior notice and without incurring any obligation to make such changes and modifications on Watts products previously or subsequently sold.