

Pump Control Valve (W-M113-46/21)

◆ Application:

When the water pump on and off, the main valve closes slowly in advance to relieve pipeline water hammer and starts pipeline check function, which can protect the pump and pipeline effectively. It's generally used in pump controlling of city water supply, industrial and agricultural water transmission pipeline, etc.

◆ Features:

1. Stable performance, safe and reliable;
2. Simple operation, convenient maintenance;
3. Long service life;
4. Remote electric control or on-site manual control.

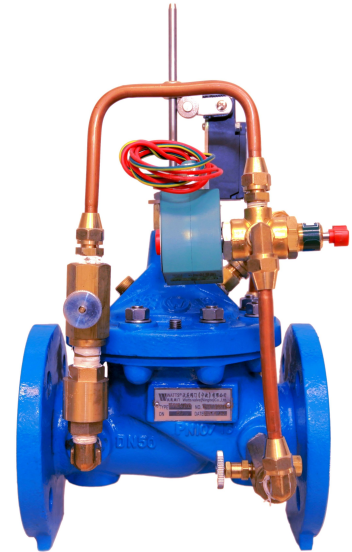

◆ Operating Principles:

The valve opens and closes by controlling the 3-way solenoid valve. When the pipeline of solenoid valve connects the upper cavity and the inlet of the valve, the valve closes, and the pump motor closes by the limit switch when the valve has closed 90%. When the pipeline of solenoid valve connects the upper cavity and the outlet of the valve, the valve opens, and the pump motor opens by the limit switch when the valve has opened 10%. Adjusting the opening and closing speed of main valve by needle type valve. Solenoid valve also has manual function.

◆ Technical Specification:

Nominal Diameter:	DN50~DN200
Maximum Working Pressure:	1.6MPa
Working Temperature:	0℃~80℃
Fluid Medium:	Water
Minimum Different Pressure:	5PSI (0.03MPa)
Control Voltage:	Standard voltage AC220 (optional 36/110V,etc)

◆ Material:

Part	Body / Bonnet	Stem	Seat	Diaphragm	Sealing
Material	Ductile Iron	Stainless Steel	Stainless Steel	NBR+Nylon	NBR

◆ Installation Dimensions:

Connection Dimension: GB/T 17241.6;

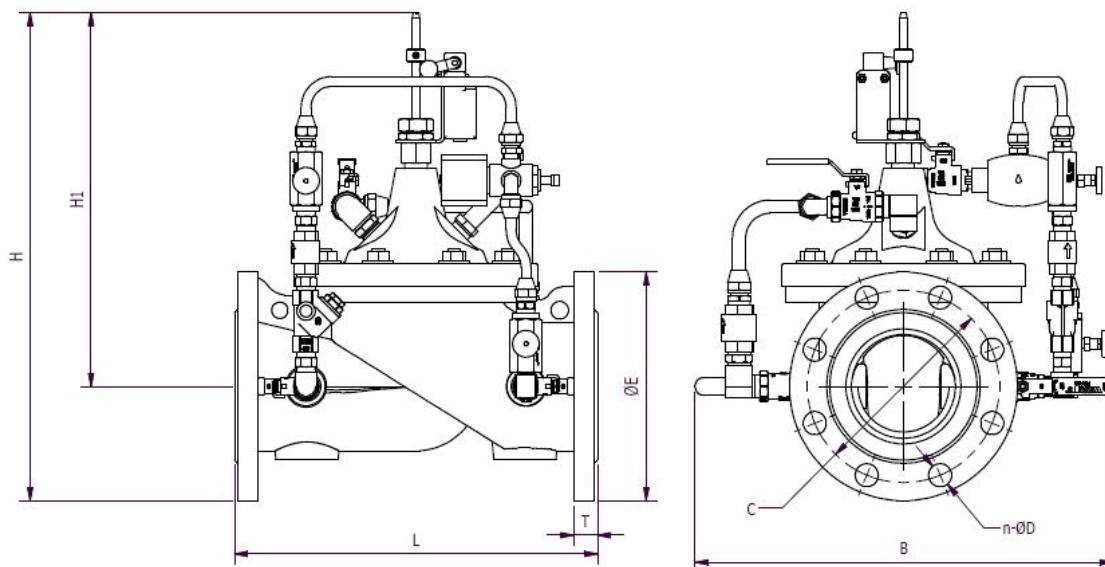

Type	Size DN	Dimensions(mm)				Flange Dimensions(mm)			
		L	H	H1	B	C	n-φD	E	T
W-M113-46	50	230	390	310	250	125	4-φ19	165	19
	65	290	410	320	265	145	4-φ19	185	19
	80	310	420	320	270	160	8-φ19	200	19
	100	350	480	370	410	180	8-φ19	220	19
	125	400	570	450	450	210	8-φ19	250	19
W-M113-21	150	480	600	455	475	240	8-φ23	285	19
	200	600	710	545	530	295	12-φ23	340	20

*Please contact the local salesmen if the size \geq DN200 are needed.

◆ Typical Application:

1. Water plant and water source project;
2. Environmental protection;
3. Municipal facilities;
4. Electric power and utilities;
5. Construction industry.

◆ Installation Instructions:

- (1) The valve's rated parameters should match the equipment's. Make sure that the valve's rated flow satisfies the actual demand;
- (2) The installer must be trained or experienced so as to operate the installation correctly;
- (3) Adjusting the speed of opening and closing by needle type throttle valve, and locking with locknut after setting;
- (4) The flow direction from inlet to outlet should be paid attention to in installation, and maintenance space around the valve is convenient to assemble;
- (5) For the size below DN150, the main valve can be installed horizontally or vertically, but horizontal installation is better. The size above DN150 only can be installed horizontally;
- (6) Valve should be checked regularly, ensuring the debris in filter being cleaned.